

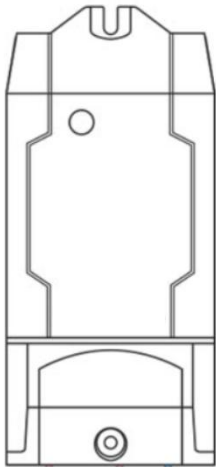

Quick Start

Model: HWM



For more info please contact us: info@denrok.com
By: Accent Automation Inc, Canada

Parameters

Power Supply: 90~220V AC
WiFi Standard: 2.4GHz b/g/n
Max Load: 16A
Output Control: 1xRelay
Supported Sensor: HWM_5M/10M

Checklist before using this device

1. Your smart phone has connected to a 2.4GHz WiFi with internet.
2. You have the correct WiFi password.
3. Your smart phone or tablet must have access to Play Store.
4. Make sure that your router is MAC-open.

User Guide

- 1 Start with "Accent-Smart Industry" APP.



- 2 Register an Accent account.
- 3 If you have Accent account, just log in.
- 4 Open the front cover, Power up.

The connected appliances work/step through live wire power on/off. The device must be powered by L and N. Earth wire is not essential.

4.1. Wiring Instruction



4.2 One wire output instruction

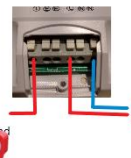

4.3. Appliances Wiring Instruction



- 5 Press the button for 7 seconds until the WiFi LED blinks continuously.

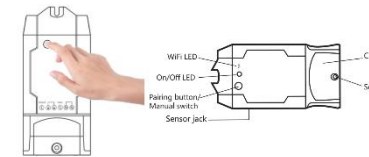

- 6 Tap + Add Device on Accent App.



- 7 Allow Location and Enter WiFi Password and then Tap Confirm button

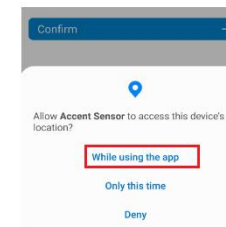

- 8 Tab Add and Name your device to complete
- 9 When your WiFi LED is blink on medium speed, the device is online, Start to measure and control now.



- 10 Tap on sensor grid for viewing realtime data.
- 11 Set Channel Width and Zero Level Setting.

Go to Realtime page > Click on three dot > More setting >



- Enter channel width in feet and then Tap Start Auto Zero
- 12 Now check realtime data, Finish!!!!